

NOTES

- WOODEN STAKES (2"x4"x5' MIN.) ON 5' CENTERS - TO SUPPORT RAIL FENCING
- BARRIER TO FORM A CONTINUOUS BARRIER AROUND THE TREE OR GROUP OF TREES
- THREE ROWS OF RAIL FENCING (2"x4") SPACED EQUALLY TO BE PLACED AROUND ALL EXISTING TREES TO REMAIN
- CONTRACTOR TO INSTALL PROTECTIVE FENCE BARRIER AROUND ALL EXISTING TREES TO REMAIN - AT THE START OF THE PROJECT - FENCE TO REMAIN IN PLACE THROUGHOUT THE DURATION OF THE PROJECT
- CONTRACTOR SHALL TAKE EXTRA CARE DURING EARTHWORK AND UTILITY OPERATIONS TO PROTECT ALL EXISTING TREES - AND SHALL BE RESPONSIBLE TO REPLACE ANY TREES DAMAGED DURING CONSTRUCTION.

APPROVED 7-2016	DEPT. OF PUBLIC WORKS ENGINEERING DIVISION CITY OF CORAL GABLES	STANDARD DETAILS TREE PROTECTION ELEVATION - N.T.S.	1 of 3
REVISED 7-2016			

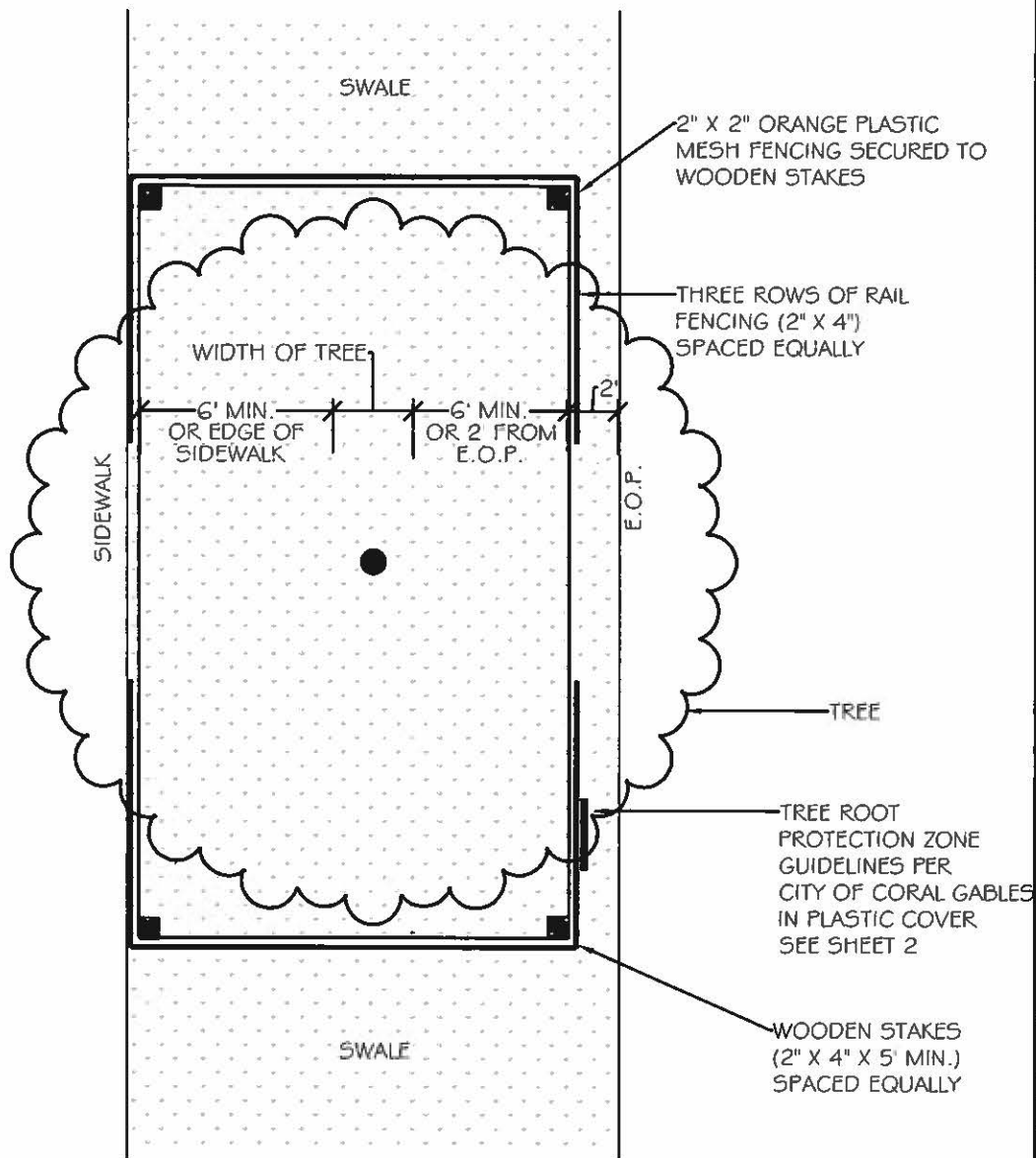

APPROVED 7-2016	DEPT. OF PUBLIC WORKS ENGINEERING DIVISION CITY OF CORAL GABLES	STANDARD DETAILS TREE PROTECTION PLAN - N.T.S.	2 of 3
REVISED 7-2016			

TREE ROOT PROTECTION ZONE

TO BE POSTED ON TREE PROTECTION FENCE - PROTECTED WITH
PLASTIC COVER

- NO EXCAVATION
- NO STORAGE OF CONSTRUCTION
BUILDING MATERIALS OR TRAILERS
- NO SPILLAGE OR DUMPING OF FUEL
OR OTHER CHEMICALS OR LIQUIDS
- NO GRADE CHANGES
- NO EQUIPMENT OPERATION
- NO ENTRANCE INTO ENCLOSURE
- NO TEMPORARY REMOVAL OF
ENCLOSURE
- CONTACT PERSON RESPONSIBLE
FOR SITE INFORMATION

APPROVED 7-2016	DEPT. OF PUBLIC WORKS	STANDARD DETAILS	3 of 3
REVISED 7-2016	ENGINEERING DIVISION	TREE PROTECTION	
	CITY OF CORAL GABLES	GUIDELINES TO POST	